

EZWall™

A high performance exterior or interior panel system for residential, commercial and industrial cladding.

EZWall™ panel system offers the customer a tested and qualified wall assembly and has a two hour fire test to British Standards. Since EZWall™ is not a laminated sandwich panel, the designer may choose a variety of suitable insulation or sheathing materials to suit the performance requirements.

EZWall™ performs floor to ceiling, ground to roof. Condensation and moisture drain through the patented Dual Weeping Mechanism. Stucco embossed EZWall™ panel is designed with a patented air equalisation cavity. Due to the unique manufacturing system the tab spacing on the panel can be customised to accommodate a variety of sizes for brick, tile, marble, stone or granite.

- 2 Hour fire test to British Standards
- Lightweight (approx. 32kg.m²)
- Cuts costs of site handling equipment, foundations & support structure
- CAD Service
- Full Site Take-Offs
- Easy to use, no skilled labour necessary
- Fast track cladding system
- Feature brickwork
- Freedom of design
- Internal / external use

Use Euroform Versapanel for a high performance, fire-rated, rot resistant backer board to this system.

Brick Colour Matching and Cutting Service Available

Please contact Euroform on **01925 860999** for further information.

Full Builds Clad

Perfect Brick Match

Lightweight Solutions

Flexibility in Design

Euroform Products Ltd
Solutions for the building industry

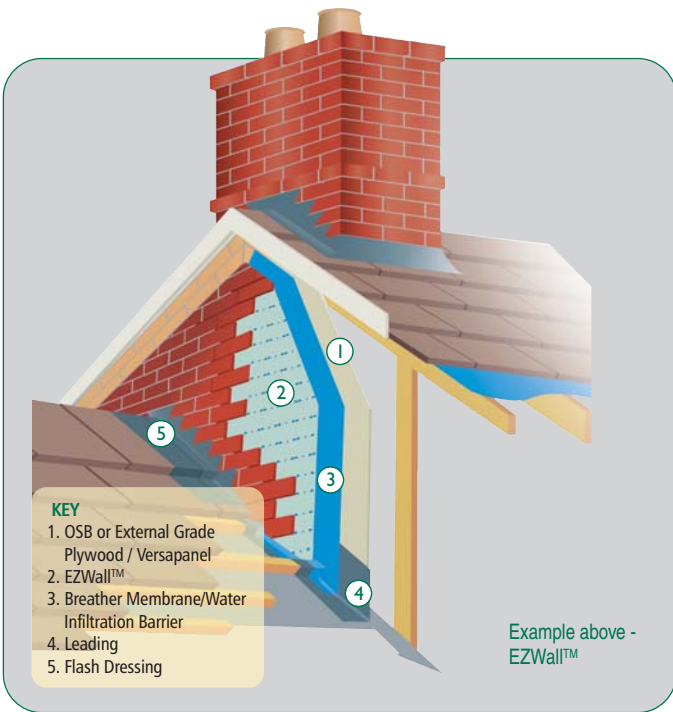

Features & Benefits

- **Dual Weeping Mechanism Design**
 - Superior drainage of accumulated moisture
- **Full Depth Mortar Joints**
 - Provides years of strength & durability
- **18 ga. Architectural G-90 Stucco Embossed Steel**
 - Creates an air equalisation cavity
 - Reduces point loading
 - Assures straight and uniform bed joints
- **Brick Ties Under Each Brick**
 - A true Mechanical Support System
- **No Special Clips Required**
 - Readily available industry standard coated fasteners are all that is required
- **EIFS*** - Exterior Insulation Finish System
- **Installation Service Available**

EZWall™ Architectural Steel Panel Benefits

27 gauge galvanised, paint-coated, stucco embossed panels with 10mm (3/8") tabs for use with thin brick veneers and 70mm (1/4") tabs for tile & stone veneers.

Panel size: 1200mm x 1200mm

- Tensile strength of steel will carry sidewall wind loading - particularly in diaphragm engineered systems.
- Is a steel ledge for the thin veneer's shear weight to rest on - a true mechanical (structural) support system.
- Double steel tab spaces the thin veneer horizontally and vertically on the panel for easy installation.
- Zinc-coated galvanised to G-90 for rust prevention for heavy-duty commercial applications.
- Steel sheet is fastened and applied to wall like any other standard siding - no special clips, hooks, trims, or strips needed.
- Allows you to fasten anywhere through the panel for even weight distribution or loading on the wall, using industry standard fasteners.
- High fastener pull-through strength for panel support and integrity.

- Hardened steel sheets help brace the wall, minimising wall racking.
- Architectural grade steel has approximately the same coefficient of thermal expansion as thin veneer and mortar.
- 13mm (1/2" high) profile that can be used with standard trims, mouldings, window and door frames.

EZ Wall offers ...

... the Designer

Choice of sizes, patterns, finishes and textures.

... the Contractor

Various methods of installation to fit budget, site and project.

... the Owner

A cost effective, aesthetically pleasing and maintenance free wall system.



Due to our policy of continuous development we reserve the right to change design and specifications without prior notice. Euroform Products Limited does not accept responsibility for any loss as a result of any company or person relying on material in this publication, or for any mistakes or misprints. Although every care is taken to ensure accuracy, this brochure is a general guide and specific technical advice is recommended before proceeding with any transaction. Specific fact sheets, or, technical information is available from Euroform technical department 01925 860999. Reproduction of any part of this publication in any manner is not permitted without prior written consent from Euroform Products Limited.

Euroform Products Ltd

The Heliport, Lyncastle Road
Appleton Warrington WA4 4SN

Tel: +44 (0)1925 860999 www.euroform.co.uk

Fax 01925 860066 **Email info@euroform.co.uk**